

- ▶ **COMPACT** optosensor with integrated amplifier
- ▶ Reflective sensor with polarizing filter
- ▶ Very well-suited for the recognition of transparent objects
- ▶ Excellent edge resolution at long range
- ▶ Robust stainless steel housing
- ▶ With cable connection or M8 connector



REFLECTIVE BEAM SENSOR with integrated amplifier

▶ **TECHNICAL DATA**

MODEL	RXLM122R	RXLM126R
Light type	red light 660nm	
Operating temperature	-10°C to +55°C	
Protection class	IP65	
Functional principle	pulsed	
Frequency response	500Hz	
Power supply indicator/Signal stability	LED red	
Operating voltage	10...30 VDC reverse polarity protection	
Current consumption	30mA	
Output current	PNP 100mA short circuit proof	
Hystereses	<15%	
Response time	<1,5ms	
Sensing distance* (not adjustable)	600mm	
Supply connection	2m PUR cable 3 x 0,10mm ²	connector M8, 3pin **
Housing material	stainless steel	
Mounting	for screw-in fixture	
Adjustment indicator	LED blinking 2Hz	
Short circuit indication	LED blinking 8Hz	

* on enclosed reflector

** cable to be ordered separately

▶ **DIMENSIONS** Measurements in mm. Subject to technical change.

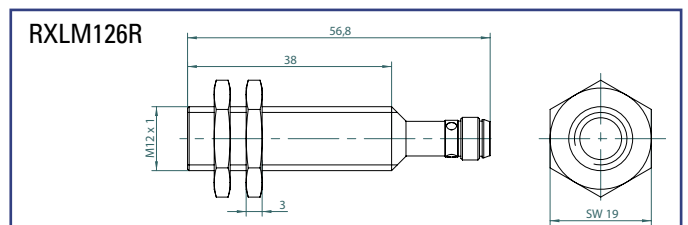
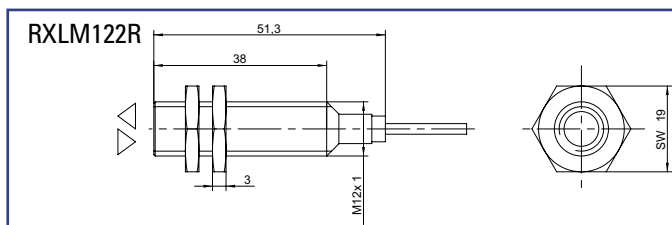

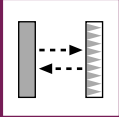

RXLM122R | RXLM126R

► **GRAPHS** (All Graphs showing typical data with STM amplifier.)

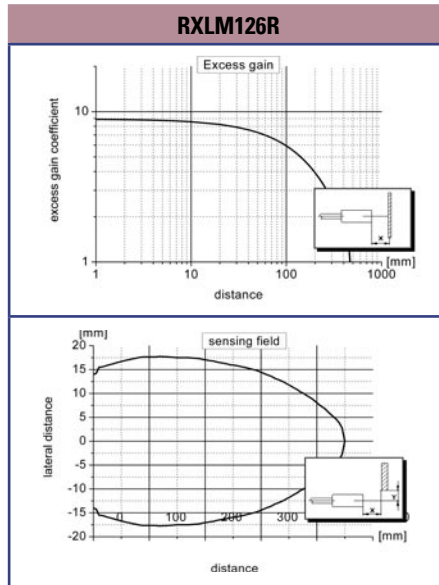
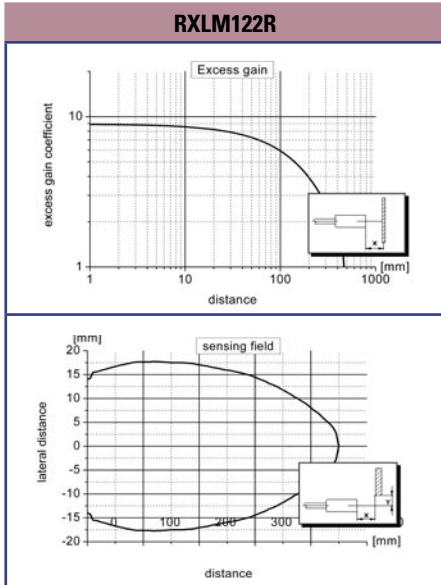

► **CONNECTION-DIAGRAM**

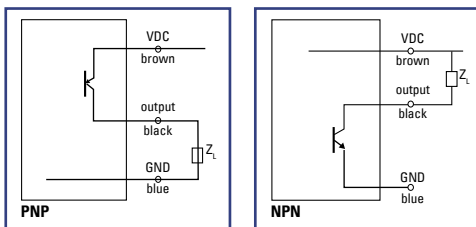

► **PIN CONNECTION**

PUR-cable, 3pin, 2m

- brown + VDC
- blue - GND
- black signal output

connector M8, 3pin

- 1 (brown) + VDC
- 3 (black) signal output
- 4 (blue) - GND

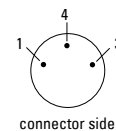

PART DESIGNATION

RXLM122R-BDP	= cable	red light	pulsed	dark-on	PNP-output
RXLM126R-BDP	= connector M8	red light	pulsed	dark-on	PNP-output
RXLM122R-BDN	= cable	red light	pulsed	dark-on	NPN-output
RXLM126R-BDN	= connector M8	red light	pulsed	dark-on	NPN-output

Please do not forget to order the appropriate power supply cable (see accessories).